



As the Wood Turns

A Newsletter of the Peaks Woodturners July Potluck Highlights

Volume 8, Issue 8

August 2015

Thanks to our gracious hosts, Carl and Debbie for a lovely and delicious dinner.



Board of Directors

- *President: Bill Dooley*
- *Vice President: Kevin Okon*
- *Secretary: Jeanette Baker*
- *Treasurer: Ernie Kurmes*
- *Program Coordinator: Don Baker
Carl Smith*



- *Videographer: Bob Fain:*

Inside this Issue

<i>Members</i>	2
<i>July Potluck</i>	2
<i>Upcoming Activities</i>	3
<i>Jan Wee preview</i>	3
<i>Who We Are</i>	4
<i>Map to Local Works</i>	5
<i>Membership Form</i>	5

From the Editor



To continue our New Year's resolution to turn safely, it's time for another installment from AAW's Safety for Woodturners. This month's excerpts are taken from an article by Nick Cook called "Safety Lessons: Twenty Ways Not To Turn A Bowl."

6. Don't turn too fast - Before mounting the stock between centers or on a faceplate or chuck, switch on the lathes without anything mounted. This will let you see where the spend was set when the lathe was last used. Reducing the speed at the end of every turning session will prevent an accident.

7. Don't hurry - It's possible to ruin a piece by stopping the lathe too quickly. If the lathe comes to an abrupt stop, your piece and the chuck can be thrown off. A safer way is to reduce the speed of the lathe slowly.

8. Don't stand in the wrong place -

Always stand to one side of the workpiece (out of the path of the spinning blank) when you turn on your lathe.

9. No roughing-out gouge for bowl work - Never turn a bowl with a roughing gouge. It is called a spindle roughing gouge for a reason. You should not use a skew on a bowl either.

10. Big gap at tool rest - One of the most common problems is extending the tool too far out over the tool rest. Once the tool extends more than 1" or so beyond the rest, stop the machine and move the tool rest closer. The height of the tool rest is determined by the tool you are using and your height and stance. Always place the tool on the rest first, touch the back of the tool to the blank, then gently lift the tool handle until the bevel makes contact with the wood. You will be less likely to get catches this way.

To be continued next month.

Jeanette Baker

Members

Members attending the July potluck were:

Kevin Okon
Don Baker
Jeanette Baker
Ernie Kurmes
Larry Gilbert
Bob Fain
Don barnes
John Armstrong
Karel Armstrong

Carl Smith
Lin Kwis
Karl Doerry
Jeff Beauchamp
Rebecca Crawford

Guests:

Marcie Barnes
Carole Gilbert
Debbie Farnum
Andi Kleinman
Elias Marshall

New members and guests are always welcome. Annual membership dues are \$30. Family membership is \$30 for the first member and \$10 for each additional member.

July Potluck



August demonstration preview, *Pyrography & painting by Jan Wee*



Upcoming Demonstrations/Activities

Aug	11	Jan Wee	Pyrography/painting	Sept	11-12	Jim Beaman	Hands-on workshop
Sept	5-6	Coconino County Fair		Oct	13	TBD	
				Nov	10	TBD	



The Peaks Woodturners is a chapter of the American Association of Woodturners. The purposes of the Peaks Woodturners are to (1) provide a meeting place for local wood turners, (2) share ideas and techniques regarding woodturning, (3) trade woods, (4) exchange ideas about tools, and (5) educate and foster the art of woodturning. Membership is open to anyone interested in woodturning.

Meetings take place on the second Tuesday of the month and begin at 6:30 p.m., unless otherwise posted. The location for meetings is 1926 N. Fourth Street, Suite 9 (behind Hunan East).

www.peakswoodturners.org

How to get to Local Works:

Local Works is located at 1926 N Fourth Street, Suite 9. From Route 66 go north on Fourth Street. Look for the strip mall with Radio Shack, Hunan East, and the Habitat for Humanity Re-Store. Park in that parking lot. To get to Local Works, go between the Re-Store and Hunan East. Suite 9 is located behind Hunan East.

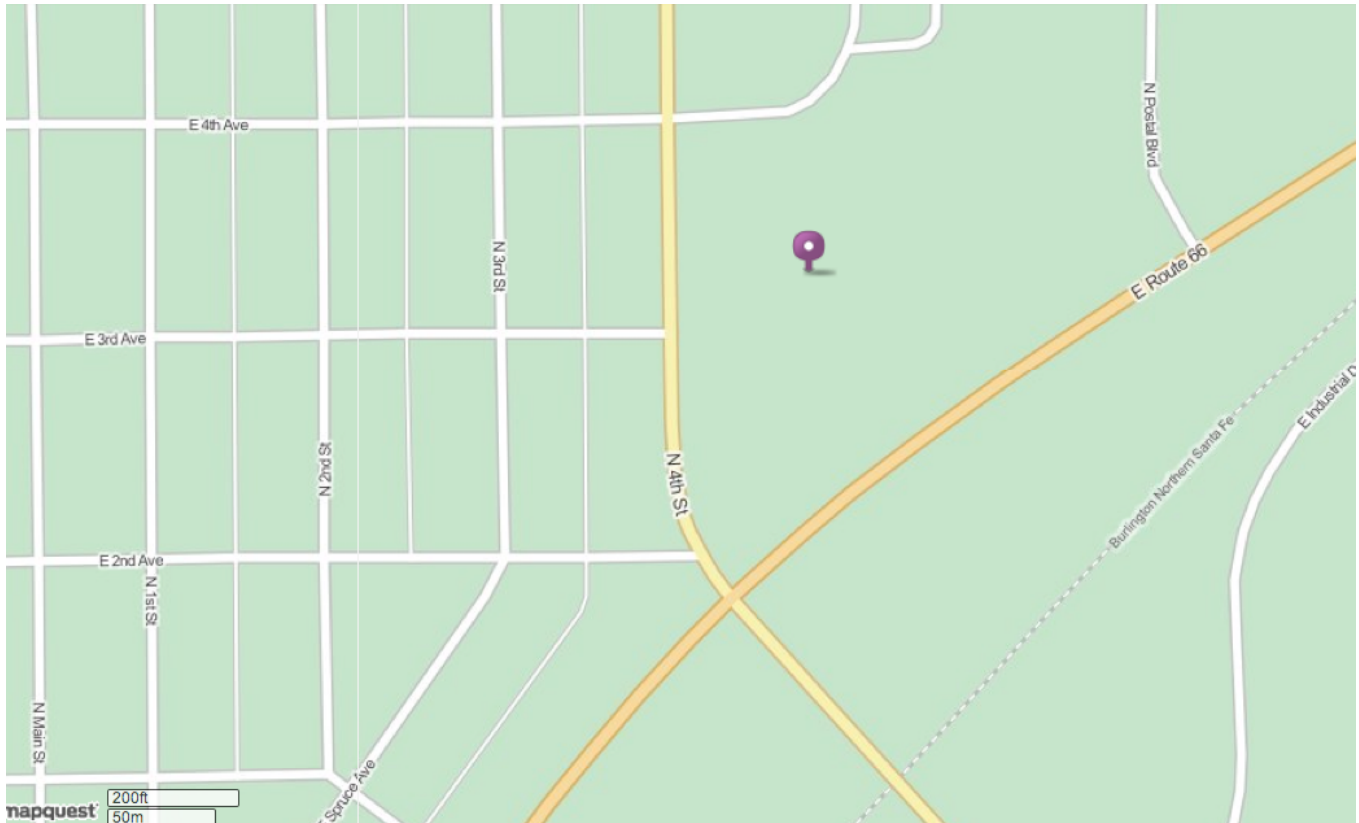

PEAKS WOODTURNERS MEMBERSHIP FORM

First Name _____ Last Name _____

Street Address _____ City _____ Zip _____

E-mail _____ Confirm e-mail _____

Phone _____ Membership (\$30/year, individual. Family: \$30 + \$10 each additional member)

Additional member(s): _____

Are you an AAW member? _____

Make Checks Payable to: **PEAKS WOODTURNERS**

Send completed form and check to:

Peaks Woodturners
c/o Ernie Kurmes
5937 E. Abbey Rd.
Flagstaff, AZ 86004

Willing to give a demonstration? _____

Topic _____

Demonstrations you'd like to see: _____

