



As the Wood Turns

A Newsletter of the Peaks Woodturners

December Potluck Highlights

Thanks to Lin for graciously hosting the holiday potluck. Much delicious food was enjoyed. Unfortunately there was not a quorum of members present for the election of officers. The election will have to be held in January now.

See pages 2 and 3 for photos.

Jeanette Baker

Volume 8, Issue 1

January 2015

◆◆RAFFLE ITEMS NEEDED◆◆

Please bring something for the raffle -- wood, tool, etc.



From the Editor

Happy New Year! Time for another installment from AAW's Safety for Woodturners. This is excerpted from an article by Lyle Jamieson titled "Safety Lessons: How to Avoid a Catch."

Complicated forces are created when shaping a revolving piece of wood with turning tools. These forces can lead to catches. If you understand what causes catches, you can eliminate the cause.

A primary way to prevent catches is to turn with sharp tools. A sharp tool can shear off end-grain fibers cleanly and smoothly. You can have all the right techniques and still have trouble with catches if your tools are not sharpened properly and often.

When doing push and pull cuts with gouges, most catches come from allowing the gouge to cut while not being supported by the bevel. The bevel is a controlling factor and prevents the gouge from cutting too aggressively.

The inside of a bowl is where catches are most apt to occur because the inside of a bowl is where we are prone to lose bevel support. The direction the gouge wants to cut is along a line from the heel of the bevel to the sharp point of the edge.

The first thing to do is relax and let the tool go where it wants. Relax the tool-rest hand and direct the cut by moving the handle hand. Relax, take a deep breath, and let your handle hand do the work.

You will get a clean cut when the flute points in the direction you want to travel with your cut. A twist of the tool will have the flute pointing at a 45-degree angle. Whenever possible, maintain this shearing cut to slice through each grain fiber cleanly as it spins past your tool. Your gouge cuts the shaving at the tip of the cutting edge.

With the bowl gouge, you follow the little tip of the tool, or the bevel. Swing the tool handle to follow the contour of the vessel with the bevel.

We often hear the phrase "ride the bevel" to describe this. You don't really want to ride the bevel. What you need to do is follow it gently. A "bevel supported cut" is a better description.

If you walk up to the lathe nervous about getting a catch, you are missing out on the true fun of woodturning.

Woodturning enjoyment starts by being in control at the lathe. Taking "catch" out of your vocabulary will make turning a lot easier and more pleasurable.



To learn more, including how to avoid catches with scrapers, go to www.woodturner.org. Since all Peaks Woodturners members also are members of the national association, AAW, you can log in to the website, click on Resources, then Safety Resources. On that page, you'll see a section called 'Resources' with two items listed underneath. The second item is the Safety for Woodturners which you can download and read at your leisure and save for reference.

Jeanette Baker

Board of Directors

- *President: Mike Dries*
- *Vice President: Rebecca Crawford*
- *Secretary: Jeanette Baker*
- *Treasurer: Ernie Kurmes*
- *Program Coordinator: Don Baker
Carl Smith*



- *Librarian: Steve Van Ooteghem*
- *Videographer: Bob Fain*
- *Outreach: Rebecca Crawford*

Inside this Issue

<i>Members</i>	2
<i>Holiday Potluck</i>	2
<i>Upcoming Activities</i>	3
<i>Holiday Potluck cont'd</i>	3
<i>Who We Are</i>	4
<i>Map to Local Works</i>	5
<i>Membership Form</i>	5

Members

Members attending the December potluck were:

Bob Fain
Lin Kwis
Rebecca Crawford
Kevin Okun
Don Barnes
Mike Dries
Terry Davis
Ernie Kurmes

Guests:

Andi Kleinman
Jeff Beauchamp
Marcy Barnes

New members and guests are always welcome. Annual membership dues are \$30. Family membership is \$30 for the first member and \$10 for each additional member.

Holiday Potluck



Continued on page 3

Holiday Potluck - *continued from page 2*



Upcoming Demonstrations/Activities

Jan. 13 Kevin Okun Sushi plates

Feb. 10 TBD



The Peaks Woodturners is a chapter of the American Association of Woodturners. The purposes of the Peaks Woodturners are to (1) provide a meeting place for local wood turners, (2) share ideas and techniques regarding woodturning, (3) trade woods, (4) exchange ideas about tools, and (5) educate and foster the art of woodturning. Membership is open to anyone interested in woodturning.

Meetings take place on the second Tuesday of the month and begin at 6:30 p.m., unless otherwise posted. The location for meetings is 1926 N. Fourth Street, Suite 9 (behind Hunan East).

www.peakswoodturners.org

How to get to Local Works:

Local Works is located at 1926 N Fourth Street, Suite 9. From Route 66 go north on Fourth Street. Look for the strip mall with Radio Shack, Hunan East, and the Habitat for Humanity Re-Store. Park in that parking lot. To get to Local Works, go between the R-Store and Hunan East. Suite 9 is located behind Hunan East.

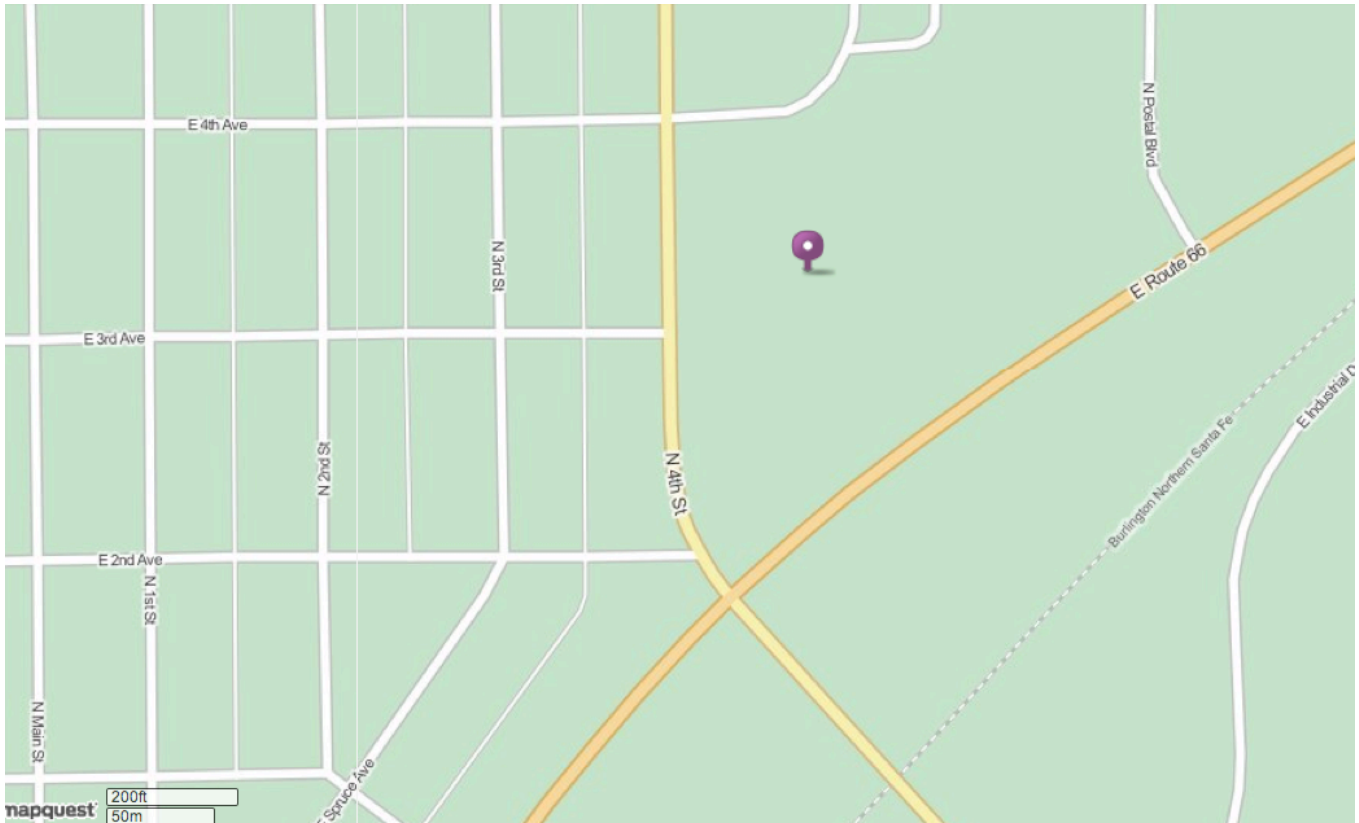

PEAKS WOODTURNERS MEMBERSHIP FORM

First Name _____ Last Name _____

Street Address _____ City _____ Zip _____

E-mail _____ Confirm e-mail _____

Phone _____ Membership (\$30/year, individual. Family: \$30 + \$10 each additional member)

Additional member(s): _____

Are you an AAW member? _____

Make Checks Payable to: **PEAKS WOODTURNERS**

Send completed form and check to:

Peaks Woodturners
c/o Ernie Kurmes
5937 E. Abbey Rd.
Flagstaff, AZ 86004

Willing to give a demonstration? _____

Topic _____

Demonstrations you'd like to see: _____
