



# As the Wood Turns

## A Newsletter of the Peaks Woodturners May Meeting Highlights

Volume 9, Issue 6

Mike called the meeting to order. Guests were introduced.

Ernie gave the treasurer's report. The beginning balance for was \$3,822.72. There were no expenses. Income included 16 cents in interest resulting in an ending balance of \$3,822.88.

Susan Mannila came to the meeting briefly to leave a notice about Ken Mannila's lathe for sale. It is a Craftsman Professional Variable Speed Wood Lathe Model No. 351.217150. He purchased it this spring and it may not

have been used. \$500 OBO. Contact (928) 380-0104.

Mike announced that his wife was looking for donations for a fundraiser for Northland Preparatory Academy.

Jeanette Baker

June 2016

### Board of Directors

- *President: Mike Dries*
- *Vice President: Bob Fain*
- *Secretary: Jeanette Baker*
- *Treasurer: Ernie Kurmes*
- *Program Coordinator: Don Baker  
John Armstrong*



- *Videographer: Bob Fain:*



### From the Editor

More safety tips from our favorite reference, *Safety for Woodturners*, from the American Association of Woodturners website. This month we continue with more tips for sharpening your tools safely from Jim Rogers.

**Wear safety protection** - A face shield and/or safety glasses should be worn while sharpening. Flying debris can cause eye injury. When dressing a wheel for cleaning or reshaping, wear a dust mask. The aluminum oxide dust from a grinding wheel is potentially damaging to the lungs.

**Proper hold** - When holding the sharpening jig, never place your hand between the jig and the grinding wheel. Place one hand on the handle of the tool and the other on top of the jig. Accidents occur when the hand hits the rotating wheel during a slippage.

**New sharpening jigs** - Until recently, most sharpening jigs managed the sharpening geometry very well, but still allowed for uncontrolled side movements

that contributed to most sharpening accidents. Two manufacturers, Sharp Fast and Oneway, have introduced jigs that eliminate the accidental sideways movement while maintaining the proper sharpening geometry.

**Other ideas for sharpening** - You can make a template to set up your sharpening jig for repeatable distances to save time and tool wear.

If you create a more acute angle on your tool, it will be placed higher up on the wheel in a safer position when sharpening.

Consider learning how to hand sharpen turning tools. This allows you to place a tool rest close to the grinding wheel, eliminating many potential dangers.

Jeanette Baker

### Inside this Issue

<i>Members</i>	2
<i>Pride &amp; Practice</i>	2
<i>May demonstration</i>	3
<i>Upcoming Activities</i>	3
<i>Who We Are</i>	4
<i>Map to Local Works</i>	5
<i>Membership Form</i>	5

## Members

Members at the May meeting were:

Ernie Kurmes  
Mike Dries  
John Armstrong  
Karel Armstrong  
Glenn Hoge  
William Weathersby  
Joel Kefuss

Guests  
Dennis Walsh  
Christina Tucker  
Bert Toivola

New members and guests are always welcome. Annual membership dues are \$30. Family membership is \$30 for the first member and \$10 for each additional member.

## Pride & Practice

Sorry, No Photos Available

---

May demonstration - John & Karel Armstong - ornamentation with burning



**Upcoming Demonstrations/Activities**

June	14	Jan Wee	Basket weave design	Aug	9	Walter Spencer	Sharpening techniques
July	12	Pot Luck	Carl & Debbie's	Sept	13	Jim Beaman	Inexpensive camera system for hollowing



---

*The Peaks Woodturners is a chapter of the American Association of Woodturners. The purposes of the Peaks Woodturners are to (1) provide a meeting place for local wood turners, (2) share ideas and techniques regarding woodturning, (3) trade woods, (4) exchange ideas about tools, and (5) educate and foster the art of woodturning. Membership is open to anyone interested in woodturning.*

*Meetings take place on the second Tuesday of the month and begin at 6:30 p.m., unless otherwise posted. The location for meetings is Local Works at 1926 N. Fourth Street, Suite 9 (behind Hunan East).*

[www.peakswoodturners.org](http://www.peakswoodturners.org)

# How to get to Local Works:

Local Works is located at 1926 N Fourth Street, Suite 9. From Route 66 go north on Fourth Street. Look for the strip mall with Radio Shack, Hunan East, and the Habitat for Humanity Re-Store. Park in that parking lot. To get to Local Works, go between the Re-Store and Hunan East. Suite 9 is located behind Hunan East.

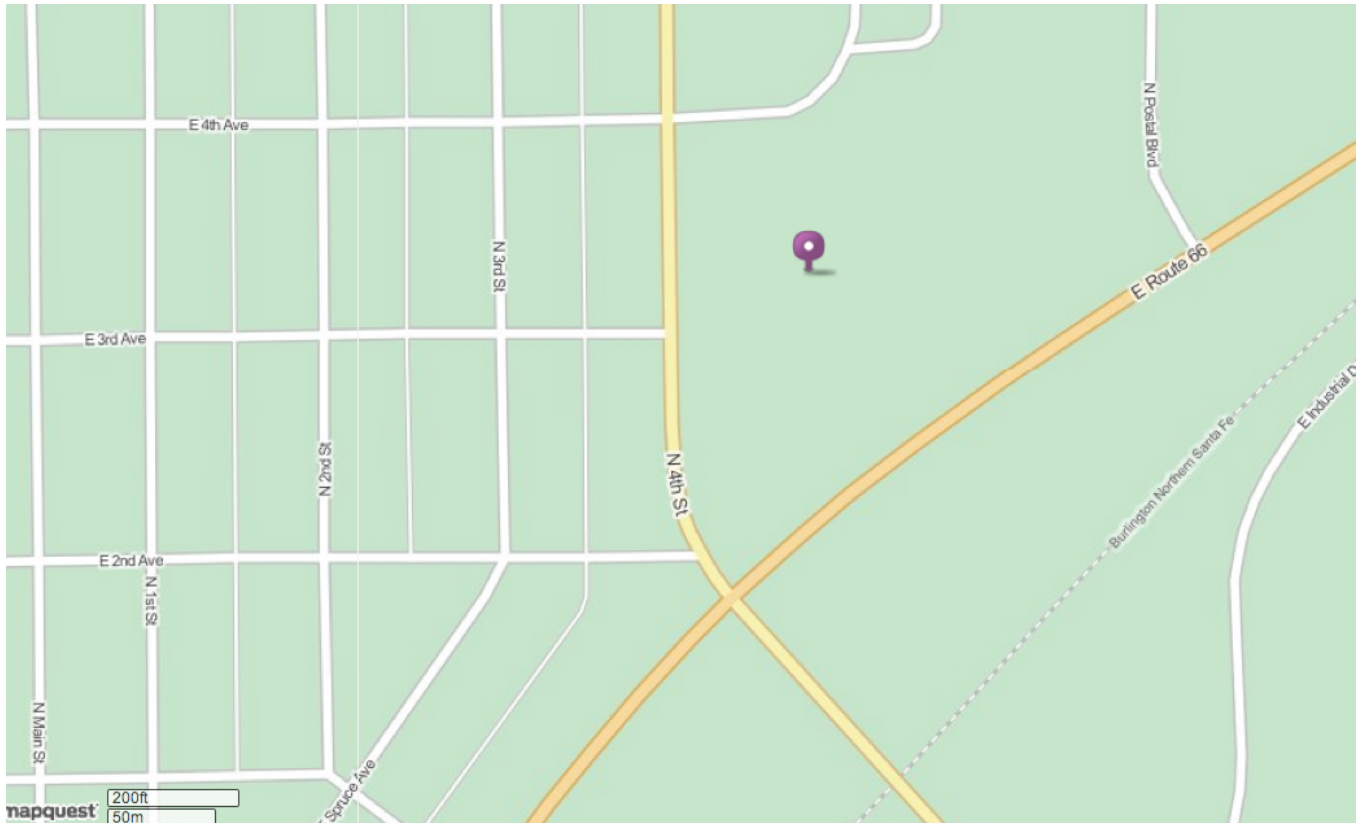

## PEAKS WOODTURNERS MEMBERSHIP FORM

First Name \_\_\_\_\_ Last Name \_\_\_\_\_

Street Address \_\_\_\_\_ City \_\_\_\_\_ Zip \_\_\_\_\_

E-mail \_\_\_\_\_ Confirm e-mail \_\_\_\_\_

Phone \_\_\_\_\_ Membership (\$30/year, individual. Family: \$30 + \$10 each additional member)

Additional member(s): \_\_\_\_\_

Are you an AAW member? \_\_\_\_\_

Make Checks Payable to: **PEAKS WOODTURNERS**

Send completed form and check to:

Peaks Woodturners  
c/o Ernie Kurmes  
5937 E. Abbey Rd.  
Flagstaff, AZ 86004

Willing to give a demonstration? \_\_\_\_\_

Topic \_\_\_\_\_

Demonstrations you'd like to see: \_\_\_\_\_

\_\_\_\_\_  
\_\_\_\_\_