



As the Wood Turns

A Newsletter of the Peaks Woodturners April Meeting Highlights

Volume 9, Issue 4

May 2016

Mike called the meeting to order. Guests were introduced.

Ernie gave the treasurer's report. The beginning balance for was \$4,496.55. Expenses were \$545 for AAW dues, \$675 to Joe Davidson for use of the facility for the year, and a \$15 reimbursement for overpayment of dues. Income included \$60 in dues, \$11 from the raffle, and 17 cents in interest resulting in an ending balance of \$3,822.72.

Bob showed club members the new storage cabinets and explained how to use the features of the cabinets. There are still some modifications needed to make them easier to use.

A motion was made and passed to reimburse Bob for the cost of materials, which should be between \$400 and \$500.

There was discussion about a topic for the May demonstration. Suggestions included sharpening techniques, how to use the skew, and a hands-on session.

Bob reported that he had been contacted by someone who is leaving Flagstaff but had a large amount of wood he would like to sell in the next six months. Types of wood include juniper, cedar, manzanita, and more.

Jeanette Baker

Board of Directors

- *President: Mike Dries*
- *Vice President: Bob Fain*
- *Secretary: Jeanette Baker*
- *Treasurer: Ernie Kurmes*
- *Program Coordinator: Don Baker
John Armstrong*



- *Videographer: Bob Fain:*



From the Editor

More safety tips from our favorite reference, *Safety for Woodturners*, from the American Association of Woodturners website. The following quiz is from Jim Rogers and addresses sharpening jigs and safety.

What can happen while sharpening a tool? The grinding wheel can fragment and tools and tool holders can slip causing serious injuries to hands and/or eyes.

Sharpening jigs were developed so that tool shape, bevel, and edge could be produced quickly and repeatedly. Tools can slide off the face of the grinding wheel and wedge between the wheel and the frame of the grinder; the arms of sharpening jigs can slip outward away from the wheel and cause the tip of the tool to move down the surface of the wheel until the tool grabs at the wheel's equator and instantly wedges itself, fracturing the wheel and potentially injuring the operator's hand.

Mechanical failure of sharpening jigs contributes to some injuries, however,

human error is more likely the cause. Here's how this can happen:

- The person sharpening the tool gets distracted.
- An improper handhold on the jig causes fingers to be driven into the still-running wheel.
- Too much pressure is applied to the tool causing mechanical slippage of the jig's arm.
- The process of sharpening is hurried.
- Small-diameter tools are placed in jigs intended for larger tools.

To use a grinding jig properly:

- Firmly lock the jig's extension arm and recheck by pushing or pulling on it.
- Place your tool high on the sharpening wheel's surface to reduce the possibility of an accident.
- Reduce the amount of downward pressure applied while sharpening to save tool steel and reduce heat buildup.

Next month's newsletter will include more tips for sharpening your tools safely.

Jeanette Baker

Inside this Issue

<i>Members</i>	2
<i>Pride & Practice</i>	2
<i>March demonstration</i>	3
<i>Upcoming Activities</i>	3
<i>Who We Are</i>	4
<i>Map to Local Works</i>	5
<i>Membership Form</i>	5

Members

Members at the April meeting were:

Ernie Kurmes
Bob Fain
Bill Dooley
Larry Gilbert
Mike Dries
John Armstrong
Karel Armstrong
Karl Doerry
Carl Smith
Harvey Cassidy

Joel Kefuss
Guests
Darren Klein

New members and guests are always welcome. Annual membership dues are \$30. Family membership is \$30 for the first member and \$10 for each additional member.

Pride & Practice



John Armstrong



Karl Doerry



April demonstration - Harvey Cassidy - bowl sanding tool

Sorry, No Photos Available

Upcoming Demonstrations/Activities

May	10	John & Karel Armstrong	Embellish with wood burning	July	12	TBD
June	14	Jan Wee	Basket weave design	Aug	9	TBD



The Peaks Woodturners is a chapter of the American Association of Woodturners. The purposes of the Peaks Woodturners are to (1) provide a meeting place for local wood turners, (2) share ideas and techniques regarding woodturning, (3) trade woods, (4) exchange ideas about tools, and (5) educate and foster the art of woodturning. Membership is open to anyone interested in woodturning.

Meetings take place on the second Tuesday of the month and begin at 6:30 p.m., unless otherwise posted. The location for meetings is Local Works at 1926 N. Fourth Street, Suite 9 (behind Hunan East).

www.peakswoodturners.org

How to get to Local Works:

Local Works is located at 1926 N Fourth Street, Suite 9. From Route 66 go north on Fourth Street. Look for the strip mall with Radio Shack, Hunan East, and the Habitat for Humanity Re-Store. Park in that parking lot. To get to Local Works, go between the Re-Store and Hunan East. Suite 9 is located behind Hunan East.

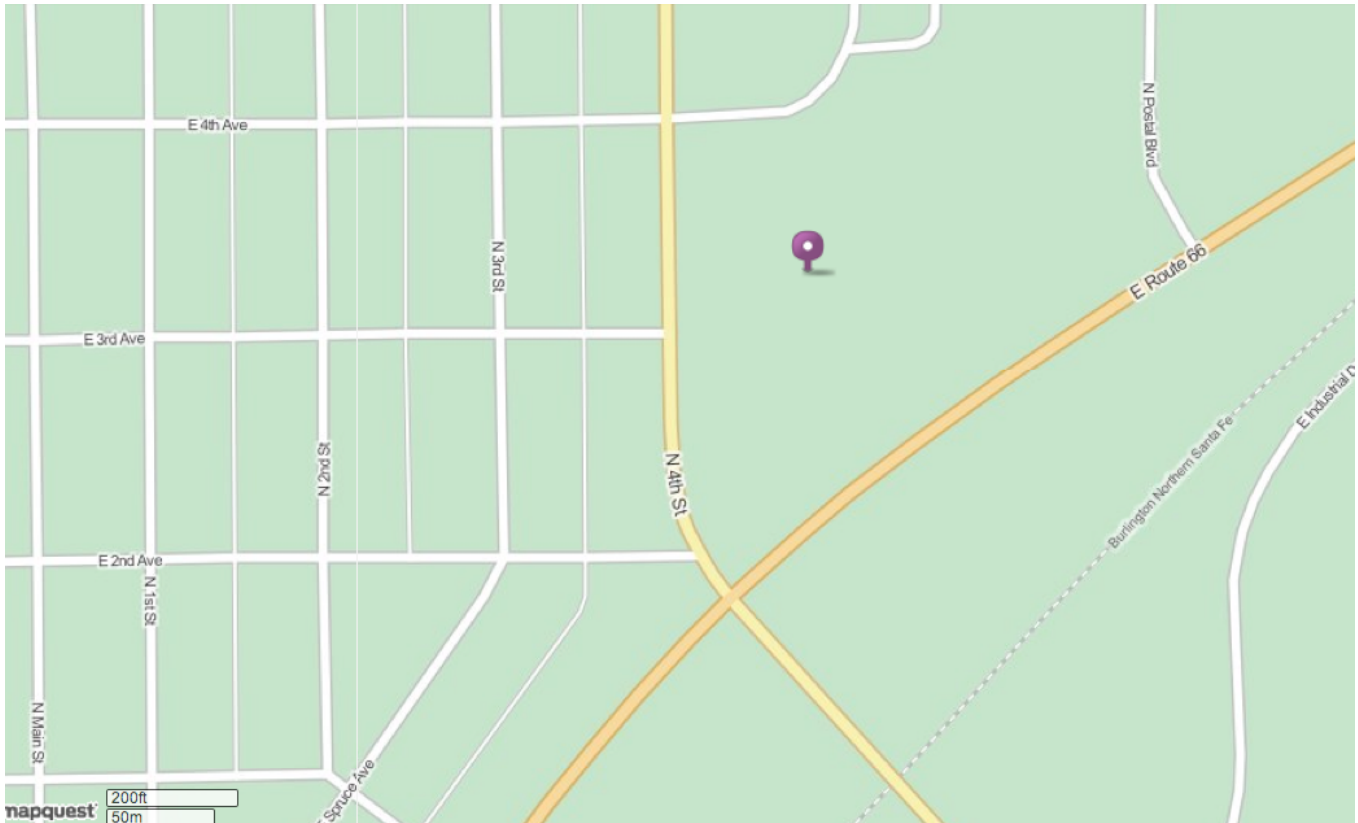

PEAKS WOODTURNERS MEMBERSHIP FORM

First Name _____ Last Name _____

Street Address _____ City _____ Zip _____

E-mail _____ Confirm e-mail _____

Phone _____ Membership (\$30/year, individual. Family: \$30 + \$10 each additional member)

Additional member(s): _____

Are you an AAW member? _____

Make Checks Payable to: **PEAKS WOODTURNERS**

Send completed form and check to:

Peaks Woodturners
c/o Ernie Kurmes
5937 E. Abbey Rd.
Flagstaff, AZ 86004

Willing to give a demonstration? _____

Topic _____

Demonstrations you'd like to see: _____

