



As the Wood Turns

A Newsletter of the Peaks Woodturners

Thanks to everyone who helped with the County Fair. Whether you were there to demonstrate, assist, and/or helped set up or tear down, it all goes to making our presence a success. Sales were low but hopefully we raised awareness about the art of woodturning.

Volume 8, Issue 10

October 2015



Board of Directors

- *President: Bill Dooley*
- *Vice President: Kevin Okon*
- *Secretary: Jeanette Baker*
- *Treasurer: Ernie Kurmes*
- *Program Coordinator: Don Baker
Carl Smith*



- *Videographer: Bob Fain:*

From the Editor



To continue our New Year's resolution to turn safely, it's time for another installment from AAW's *Safety for Woodturners*. This month's excerpts are taken from an article by Nick Cook called "Safety Lessons: Twenty Ways **Not** To Turn A Bowl."

16. Use too much pressure (Don't) - A common problem is applying too much pressure when cutting the surface. This forces the heel of the tool into the surface, bruising the fibers and leaving lines that remain invisible until you apply finish. Relax and let the cutting edge do the work, rather than forcing it.

17. Use the wrong screws (Don't) - When screwing a blank to a faceplate, don't use drywall screws; they are too thin and too brittle. Sheet metal screws are a better choice. Make sure you choose a length that is appropriate - one size does not fit all.

18. Difficult grain - You also must consider the material into which you will be putting the screws. End grain requires larger and longer screws. Sapwood does not hold screws as well as heartwood and neither does punky or spalted wood. To be on the safe side, bring up the tailstock with a live center for insurance and to give additional support if the screws do not hold.

19. Poor grip - When using a 4-jaw scroll chuck, make sure the tenon is large enough or the recess is deep enough for the chuck to get a good grip on the wood. Punky wood and sapwood present the same challenges as noted above.

20. Loose fit - Green wood requires you to tighten the jaws of the chuck repeatedly as moisture is forced from the blank. Remember to use the tailstock and center whenever possible.

Turn safely and have fun. Think about what you are doing and consider the risks involved. If you are unsure, ask someone with more experience. If it looks dangerous, it probably is.

Jeanette Baker

Inside this Issue

<i>Members</i>	2
<i>County Fair Saturday</i>	2
<i>County Fair Sunday</i>	3
<i>Upcoming Activities</i>	3
<i>Who We Are</i>	4
<i>September workshop</i>	4
<i>Map to Local Works</i>	5
<i>Membership Form</i>	5

Members

Members working at the County Fair were:

Don Baker
Jeanette Baker
Ernie Kurmes
Larry Gilbert
Bob Fain
John Armstrong
Karel Armstrong
Lin Kwis
Karl Doerry

Bill Dooley
Bob Belton
Mike Dries
William Weathersby
Don Barnes

New members and guests are always welcome. Annual membership dues are \$30. Family membership is \$30 for the first member and \$10 for each additional member.

County Fair - Saturday



County Fair - Sunday



Upcoming Demonstrations/Activities

Oct	13	Bob Belton	Segmented turning	Dec.	TBD	Holiday potluck	
Nov	10	Gary Frank	Wave bowls	Jan.	12	Larry Gilbert	Coffee scoop??



The Peaks Woodturners is a chapter of the American Association of Woodturners. The purposes of the Peaks Woodturners are to (1) provide a meeting place for local wood turners, (2) share ideas and techniques regarding woodturning, (3) trade woods, (4) exchange ideas about tools, and (5) educate and foster the art of woodturning. Membership is open to anyone interested in woodturning.

Meetings take place on the second Tuesday of the month and begin at 6:30 p.m., unless otherwise posted. The location for meetings is 1926 N. Fourth Street, Suite 9 (behind Hunan East).

www.peakswoodturners.org

September hands-on workshop with Jim Beaman



How to get to Local Works:

Local Works is located at 1926 N Fourth Street, Suite 9. From Route 66 go north on Fourth Street. Look for the strip mall with Radio Shack, Hunan East, and the Habitat for Humanity Re-Store. Park in that parking lot. To get to Local Works, go between the Re-Store and Hunan East. Suite 9 is located behind Hunan East.

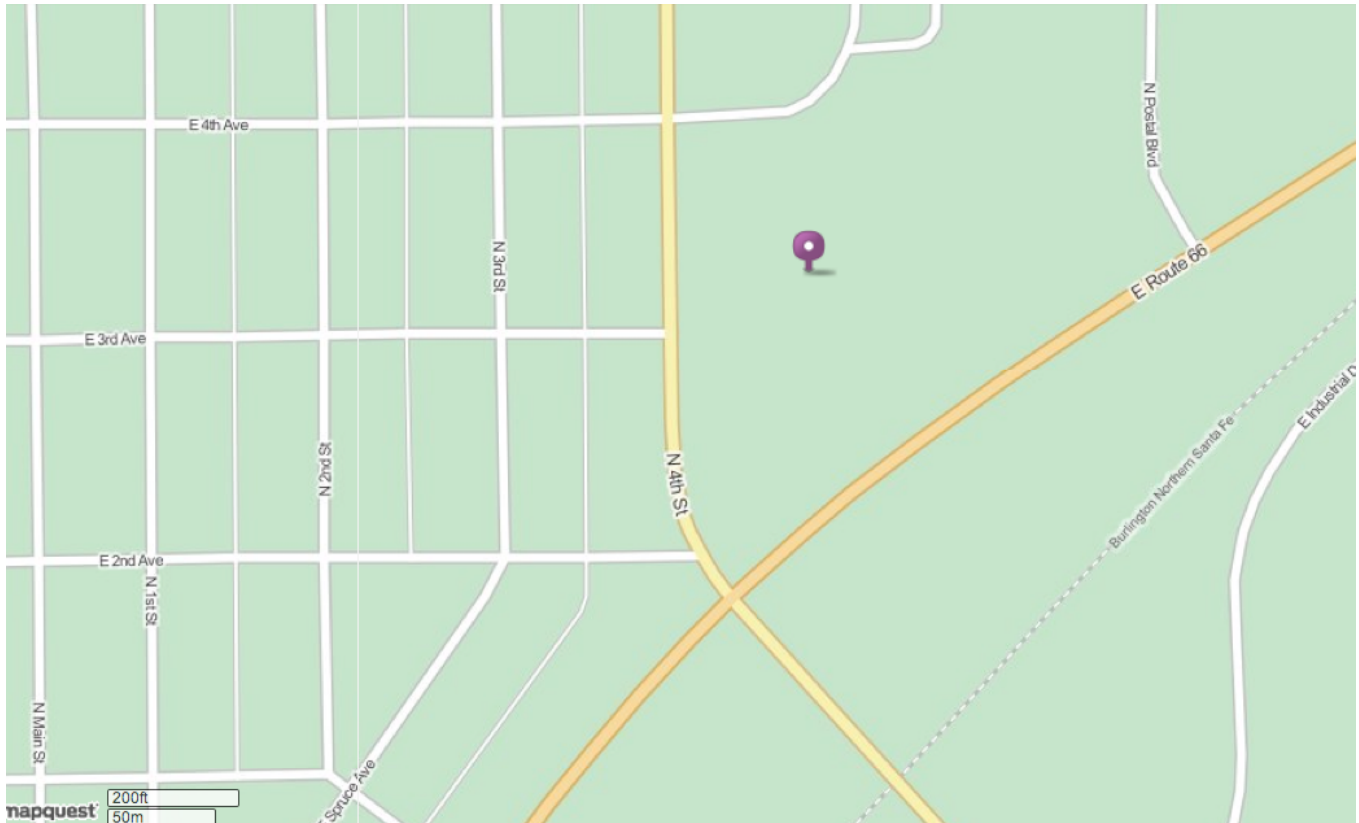

PEAKS WOODTURNERS MEMBERSHIP FORM

First Name _____ Last Name _____

Street Address _____ City _____ Zip _____

E-mail _____ Confirm e-mail _____

Phone _____ Membership (\$30/year, individual. Family: \$30 + \$10 each additional member)

Additional member(s): _____

Are you an AAW member? _____

Make Checks Payable to: PEAKS WOODTURNERS

Send completed form and check to:

Peaks Woodturners
c/o Ernie Kurmes
5937 E. Abbey Rd.
Flagstaff, AZ 86004

Willing to give a demonstration? _____

Topic _____

Demonstrations you'd like to see: _____

