



# As the Wood Turns

## A Newsletter of the Peaks Woodturners August Meeting Highlights

Volume 9, Issue 8

September 2016

Bob called the meeting to order. Guests were introduced.

Minutes from the June meeting were approved as presented.

Ernie gave the treasurer's report. The beginning balance for June was \$3,407.01. Expenses were \$150 for Jan Wee, the June demonstrator. Income included \$13 from the raffle and 14 cents in interest resulting in an ending balance of \$3,270.15. The only change for July was the addition of 14 cents in interest for an ending balance of \$3,270.29.

Bob mentioned the upcoming It's Elemental exhibition at the Coconino Center for the Arts which is scheduled to run from November 15 through December 17. The club ordinarily holds a demonstration and sale at the craft show of the exhibition. The dates for this year are December 3-4. There will be a sign-up sheet as we get closer to the date.

Bob encouraged members to submit turned items for consideration to be included in the juried show. The closing date for submissions is September 20. The application and instructions are available on the Flagstaff Arts Council website.

John asked about the impact of the increased AAW dues that go into effect in

October. Currently club members pay \$30 for an individual membership and an additional \$10 for each family member. It was decided several years ago that the club should pay each member's AAW national membership. This resulted in expenditures by the club of \$15 to AAW for each membership because basic online AAW membership has been \$45. The reason for this decision was to get more members covered by the AAW insurance so that they could demonstrate at meetings and other club events.

AAW is raising the basic online membership dues to \$50 per year, which would require Peaks Woodturners to pay \$20 out of the treasury to AAW for each member, if nothing changes.

There was discussion about whether to increase local club dues to cover the full cost of online AAW national membership or just raise club dues by \$5 and maintaining the current imbalance of revenue and expense. Various other options were discussed as well.

It was decided that it would be helpful for members to give this some thought and be prepared to discuss further and take action at the next meeting.

Jeanette Baker

tailstock. Are they secure and in the right position?

Is the wood secure on the lathe? Are the chuck jaws tight and flush against the wood for bowls and is your tailstock secure your work between centers? Does the work spin freely and evenly?

Remove all clutter from around your lathe and make sure there is nothing around your feet to trip on or stumble over.

Next month we will review a daily maintenance schedule.

Jeanette Baker

### Board of Directors

- *President: Mike Dries*
- *Vice President: Bob Fain*
- *Secretary: Jeanette Baker*
- *Treasurer: Ernie Kurmes*
- *Program Coordinator: Don Baker  
John Armstrong*



- *Videographer: Bob Fain:*

### Inside this Issue

<i>Members</i>	2
<i>Pride &amp; Practice</i>	2
<i>August demonstration</i>	3
<i>Upcoming Activities</i>	3
<i>Who We Are</i>	4
<i>Map to Local Works</i>	5
<i>Membership Form</i>	5



### From the Editor

This month this column will begin a series on lathe maintenance, which I believe is related to safety. Much of what you will read here is based on a website called [TurningForProfit.com](http://TurningForProfit.com).

Before getting into specific maintenance issues, it's good to review some basic safety measures on and around the lathe.

Before turning on your lathe, assess its main parts - the headstock, tool rest, and

# Members

Members at the August meeting were:

Ernie Kurmes  
Mike Dries  
John Armstrong  
Karel Armstrong  
William Weathersby  
Joel Kefuss  
Bob Fain  
Don Baker  
Jeanette Baker  
Larry Gilbert

Carl Smith

Guests

Joe Skala  
Alan Veale

New members and guests are always welcome. Annual membership dues are \$30. Family membership is \$30 for the first member and \$10 for each additional member.



## August demonstration - Walter Spencer - sharpening techniques



### Upcoming Demonstrations/Activities

Sept	13	Jim Beaman	Camera system for hollowing
Oct	11	The Armstrongs	Christmas ornament



---

*The Peaks Woodturners is a chapter of the American Association of Woodturners. The purposes of the Peaks Woodturners are to (1) provide a meeting place for local wood turners, (2) share ideas and techniques regarding woodturning, (3) trade woods, (4) exchange ideas about tools, and (5) educate and foster the art of woodturning. Membership is open to anyone interested in woodturning.*

*Meetings take place on the second Tuesday of the month and begin at 6:30 p.m., unless otherwise posted. The location for meetings is Local Works at 1926 N. Fourth Street, Suite 9 (behind Hunan East).*

[www.peakswoodturners.org](http://www.peakswoodturners.org)

# How to get to Local Works:

Local Works is located at 1926 N Fourth Street, Suite 9. From Route 66 go north on Fourth Street. Look for the strip mall with Radio Shack, Hunan East, and the Habitat for Humanity Re-Store. Park in that parking lot. To get to Local Works, go between the Re-Store and Hunan East. Suite 9 is located behind Hunan East.

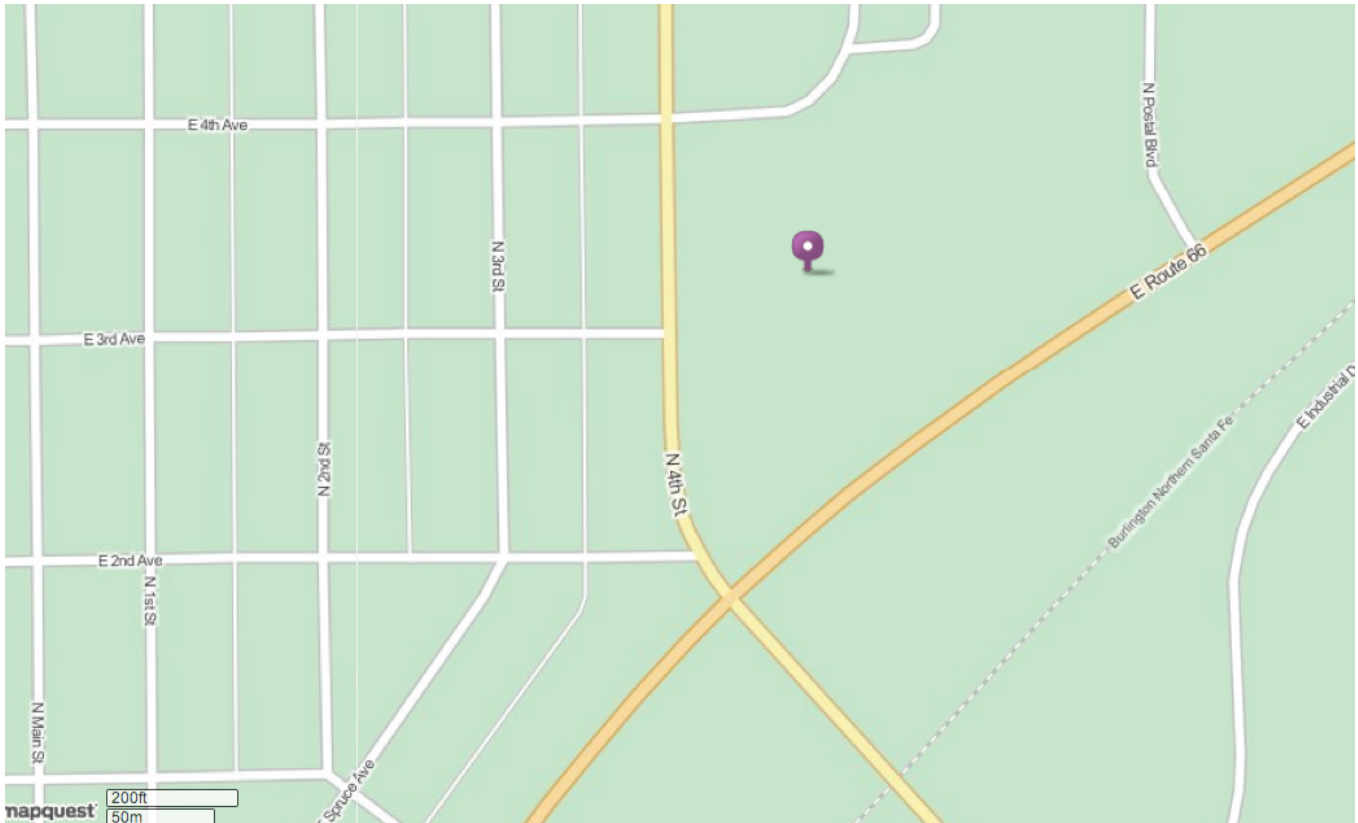

## PEAKS WOODTURNERS MEMBERSHIP FORM

First Name \_\_\_\_\_ Last Name \_\_\_\_\_

Street Address \_\_\_\_\_ City \_\_\_\_\_ Zip \_\_\_\_\_

E-mail \_\_\_\_\_ Confirm e-mail \_\_\_\_\_

Phone \_\_\_\_\_ Membership (\$30/year, individual. Family: \$30 + \$10 each additional member)

Additional member(s): \_\_\_\_\_

Are you an AAW member? \_\_\_\_\_

Make Checks Payable to: **PEAKS WOODTURNERS**

Send completed form and check to:

Peaks Woodturners  
c/o Ernie Kurmes  
5937 E. Abbey Rd.  
Flagstaff, AZ 86004

Willing to give a demonstration? \_\_\_\_\_

Topic \_\_\_\_\_

Demonstrations you'd like to see: \_\_\_\_\_

\_\_\_\_\_  
\_\_\_\_\_